

The Isabella

Apartments 208, 308 & 408*

2 BR/1 Bath

- In home washer/dryer
- Huge balcony
- Individual central heating & cooling with Nest thermostats
- USB charging outlets
- Fabulous kitchens with islands, glass backsplash, espresso wood cabinets, granite counters, stainless steel appliances, dishwashers, microwave ovens and gas cooking ranges
- Spa-like bathrooms with Cliff Pointe tile
- Oversized closets
- Double vanity sink
- Natural wood flooring
- Energy efficient double paned windows

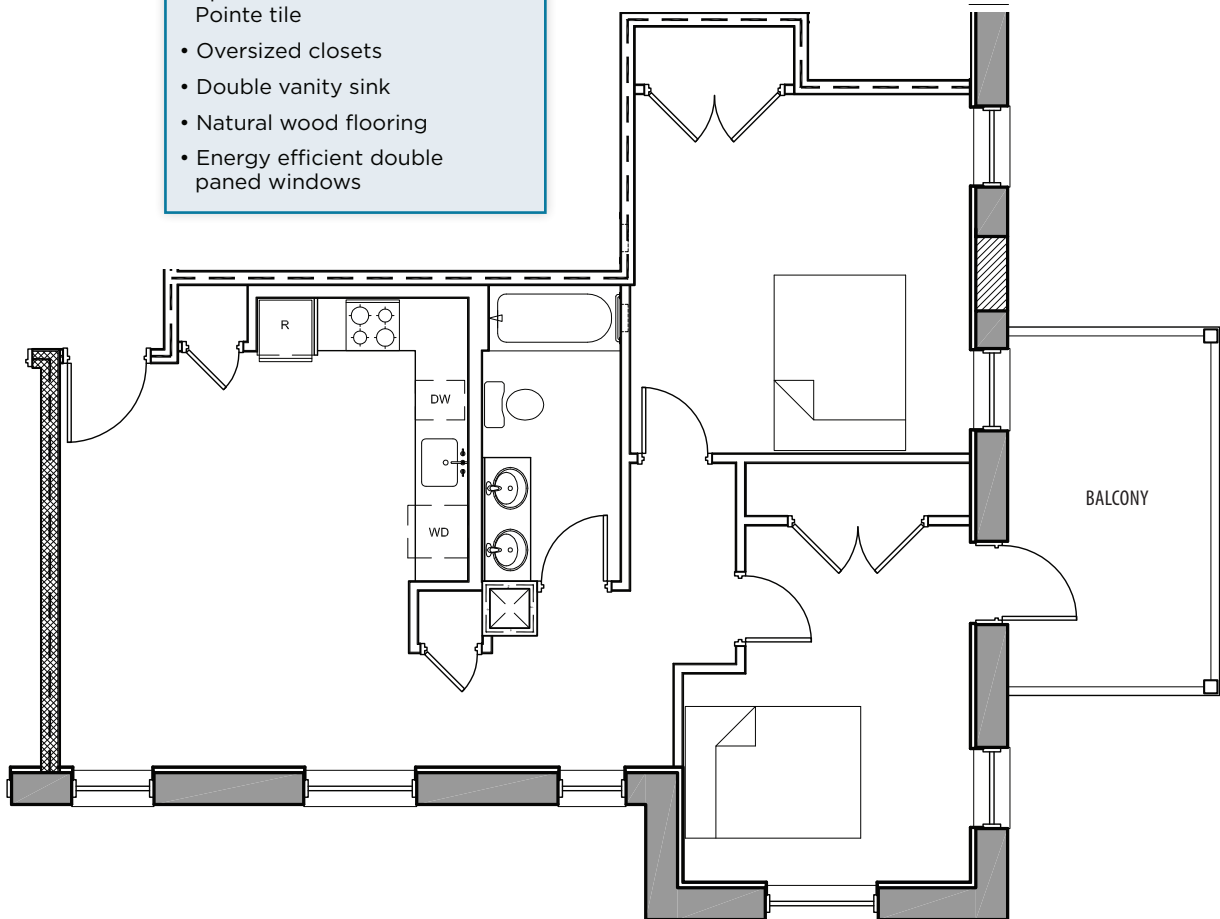

**Square footage and room dimensions are approximate, and may vary.*

Washington, DC 20010

COLUMBIA HEIGHTS

www.1483newton.com

1483newton@uippm.com

(202) 885-9785



professional ◦ courteous ◦ reliable